

## Помпа потопяема дренажна за мръсна вода Tsurumi KTZ67.5

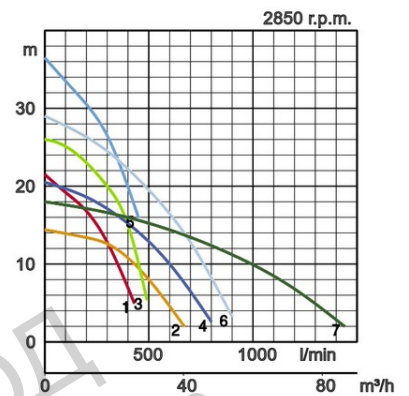

Discharge bore mm		50, 80, 100, 150	
Pumping Fluid	Temperature	0-40°C	
	Type of Fluid	Spring water, Rain water, Ground water, Sand carrying water	
Pump	Components	Impeller	Semi-open type impeller
		Shaft Seal	Double mechanical seal
		Bearings	Shielded ball bearings
	Material	Impeller	Chromium iron casting
		Casing	Grey iron casting EN-GJL-200
		Suction Plate	Ductile iron casting EN-GJS-500-7
		Shaft Seal	Silicon carbide in oil bath
Motor	Type, Poles	Induction motor, 2 poles, IP68	
	Lubrication	Turbine oil (ISO VG32)	
	Motor Protector (built-in)	Circle thermal cut-out	
	Insulation	Insulation class F	
	Phase / Voltage	3-phase / 400V / 50Hz / d.o.l.	
	Material	Casing	Grey iron casting EN-GJL-200
		Shaft	Stainless steel EN-X30Cr13
		Cable	Rubber, NSSHÖU
Discharge Connection		Threaded flange/Hose coupling	



### Components:

- 001 Cable
- 006 Cable entrance
- 020 Pump casing
- 021 Impeller
- 022 Suction plate
- 023 Strainer
- 025 Mechanical seal
- 026 Oil sealing
- 030 Oil lifter
- 032 Hose coupling
- 035 Oil plug

- 036 Lubricant
- 050 Motor cover
- 052A Upper bearing
- 052B Lower bearing
- 053 Motor protector
- 054 Shaft
- 055 Rotor
- 056 Stator
- 060 Bearing housing
- 064 Motor casing
- 068 Handle

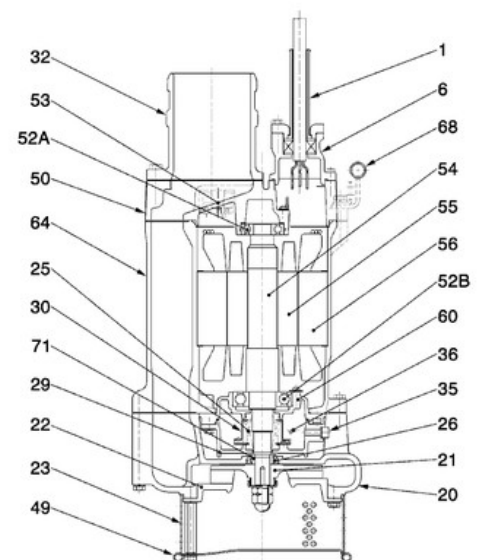

KTZ611



## Dimensions in mm:

Model	A	A1	B	D	H	W1
KTZ21.5	235	173	529	216	648	120
KTZ31.5	235	173	529	216	648	120
KTZ22.2	235	173	549	216	668	120
KTZ32.2	235	173	549	216	668	120
KTZ23.7	283	213	667	252	637	150
KTZ33.7	283	213	677	252	637	150
KTZ43.7	283	213	687	252	637	150
KTZ35.5	306	223	721	258	688	150
KTZ45.5	379	306	731	258	688	150
KTZ47.5	330	245	812	314	697	190
KTZ67.5	361	285	874	314	697	190
KTZ411	374	260	864	350	740	190
KTZ611	374	260	884	350	740	190
KTZ415	428	374	864	350	740	190
KTZ615	457	374	884	350	740	190

## Specifications:

Model	Colour code curve	Bore mm	Motor output kW	Rated current A	Head max. m	Capacity max. l/min	Dry weight kg w/o cable	Max. solid handling ø mm	Pressure resistance max. m	Cable length m
KTZ21.5	1	50	1,5	3,5	21,5	430	35,0	8,5	25	20
KTZ31.5	2	80	1,5	3,5	14,4	670	34,0	8,5	25	20
KTZ22.2	3	50	2,2	5,0	26,0	500	36,0	8,5	25	20
KTZ32.2	4	80	2,2	5,0	20,4	800	35,0	8,5	25	20
KTZ23.7	5	50	3,7	7,7	36,5	450	62,0	8,5	25	20
KTZ33.7	6	80	3,7	7,7	29,0	900	62,0	8,5	25	20
KTZ43.7	7	100	3,7	7,7	18,0	1440	62,0	8,5	25	20
KTZ35.5	8	80	5,5	11,4	32,0	1100	76,0	8,5	25	20
KTZ45.5	9	100	5,5	11,4	22,5	1740	77,0	8,5	25	20
KTZ47.5	10	100	7,5	15,1	40,0	1400	100,0	12	25	20
KTZ67.5	11	150	7,5	15,1	31,0	2030	99,0	20	25	20
KTZ411	12	100	11,0	22,0	48,5	1440	130,0	12	25	20
KTZ611	13	150	11,0	22,0	32,5	2440	131,0	20	25	20
KTZ415	14	100	15,0	28,3	55,0	1980	146,0	12	25	20
KTZ615	15	150	15,0	28,3	39,5	2800	146,0	20	25	20

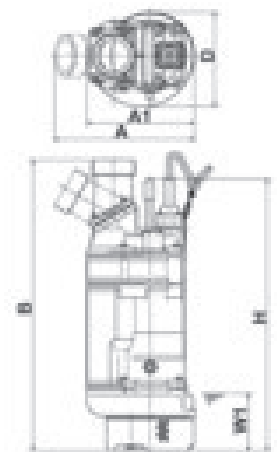

W1: lowest running water level